

WELCOME

Thank you for attending our public consultation today.

We are presenting a fantastic opportunity to **provide £1.5m of private sector funding** to improve Glazebury's community facilities.

We need to understand the issues facing existing community assets and facilities, and the specific needs of Glazebury's community groups and therefore, **we need your input!**

How? Come and speak to one of our representatives, and provide feedback on our **Questionnaire**.

Your opinions and feedback are vital to inform future community development in the village!

So **Have Your Say!**

ISSUES

CRICKET PAVILION NOT TO STANDARD / LACKING AMENITIES



SCHOOL CAR PARK AT CAPACITY



CONGESTION / PARKING TO HURST LANE



GRAVEYARD ALMOST AT CAPACITY



COMMUNITY SPACE / USES NO LONGER AVAILABLE



THE VISION *Our vision and initial concept includes:*

• INVESTMENT IN THE GLAZEBURY COMMUNITY

£1.5 million of investment to facilitate significant community benefits and facilities funded via enabling residential development.

• A NEW COMMUNITY HUB FOR GLAZEBURY

Provide a new **multi functional community building** with a modern space that can facilitate a range of uses and activities that the residents of Glazebury, and beyond, can benefit from.

• IMPROVEMENTS TO EXISTING FACILITIES IN THE COMMUNITY

Identifying areas in the village requiring **investment, improvement and enhancement**.

• LONG TERM AND SUSTAINABLE FUTURE

Providing investment and facilities that create **long term, sustainable, and high-quality** improvements for the Glazebury community.



OPPORTUNITIES



A HUB FOR THE COMMUNITY

- Opportunity to provide a new hub building for community user groups
- Potential to hold community events and a range of other activities to benefit the residents of Glazebury
- Easily accessible and suitable for all ages and abilities
- Potential to deliver a high quality, modern, and fit for purpose building



A SPACE TO GATHER

- Opportunity to hold a range of other community uses including fete's, coffee mornings, recreational activities (yoga, art classes etc)
- Potential for a range of user groups and clubs to use the space



A PLACE TO EAT AND DRINK

- Potential to include catering facilities to serve hot and cold food and drinks
- Potential to accommodate tea / coffee mornings
- Ability to provide food and drinks during community events, matchdays and hold community meetings



IMPROVEMENTS TO THE SCHOOL

- Potential to create a safer school drop-off and pick-up area
- Opportunity to allow for the expansion of school car parking
- Potential to provide the school with additional facilities and increased outdoor areas



A NEW HOME FOR CRICKET

- Potential to enhance the existing cricket ground and outfield
- Potential to hold larger cricket events including a viewing platform
- Enhanced facilities to enable a more suitable place to spectate and enjoy sports
- Potential to encourage additional members, a junior team and a female team with new facilities provided in the community hub building



OPPORTUNITY TO EXPAND VILLAGE OFFER

- Potential to supplement the cricket provision with alternative sporting provision (junior football pitches etc)
- Potential to provide additional playing fields to be used by the school and the wider community
- Potential for new clubs to use junior football pitches / facilities
- Extension to graveyard



BETTER MOVEMENT AND PARKING

- Opportunity to improve pedestrian / child safety along Hurst Lane at peak times
- Opportunity to incorporate more formal / appropriate parking the community / school / cricket events etc safely off Hurst Lane

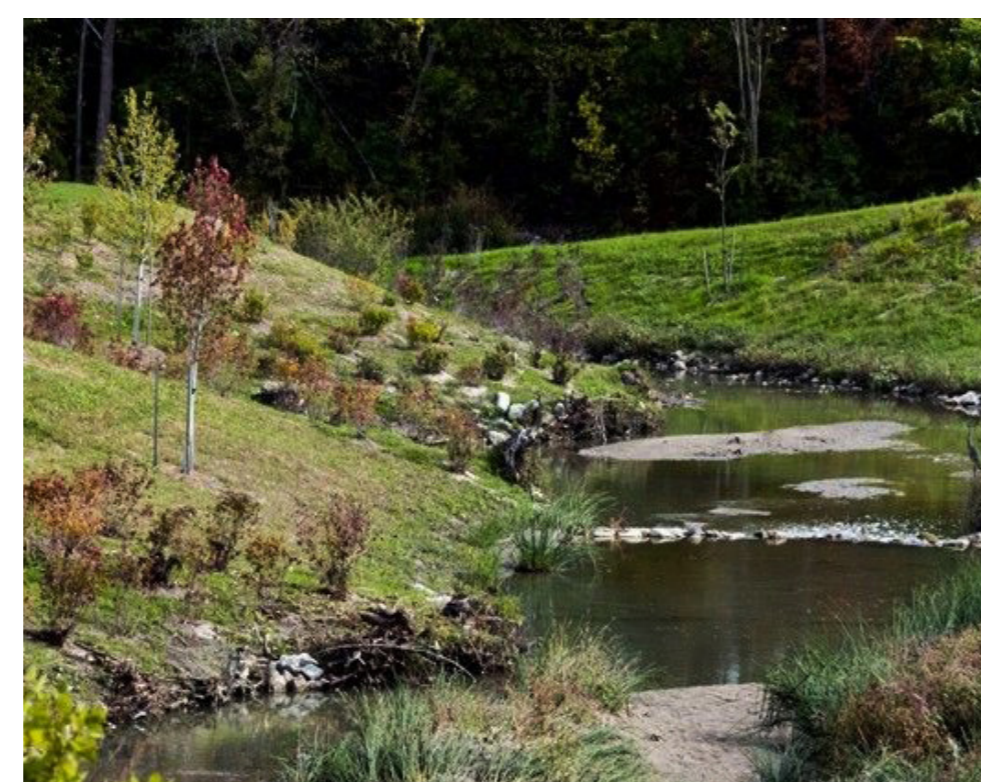

LOCAL ENVIRONMENT

- Potential to provide for walking and cycling routes and connections
- Opportunity to connect to play area and allotments over Carr Brook
- Improve quality of access to the adjacent countryside and the footpath network
- Potential to facilitate improvements to Carr Brook and deliver significant ecological and biodiversity enhancements

OPPORTUNITIES

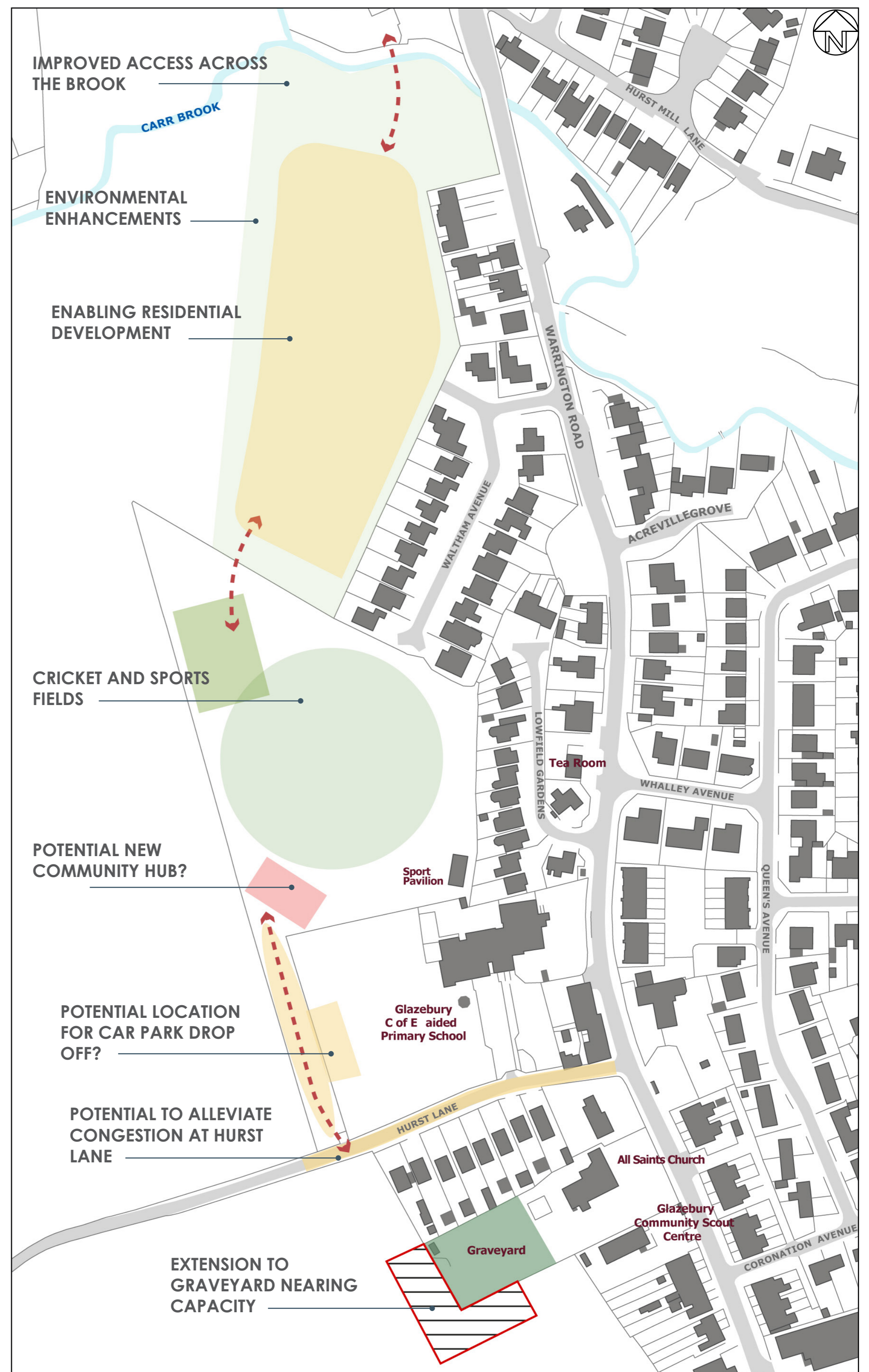

DESIGN DRIVERS

ENHANCING LOCAL BIODIVERSITY AND GREEN SPACE

INVESTING IN THE COMMUNITY

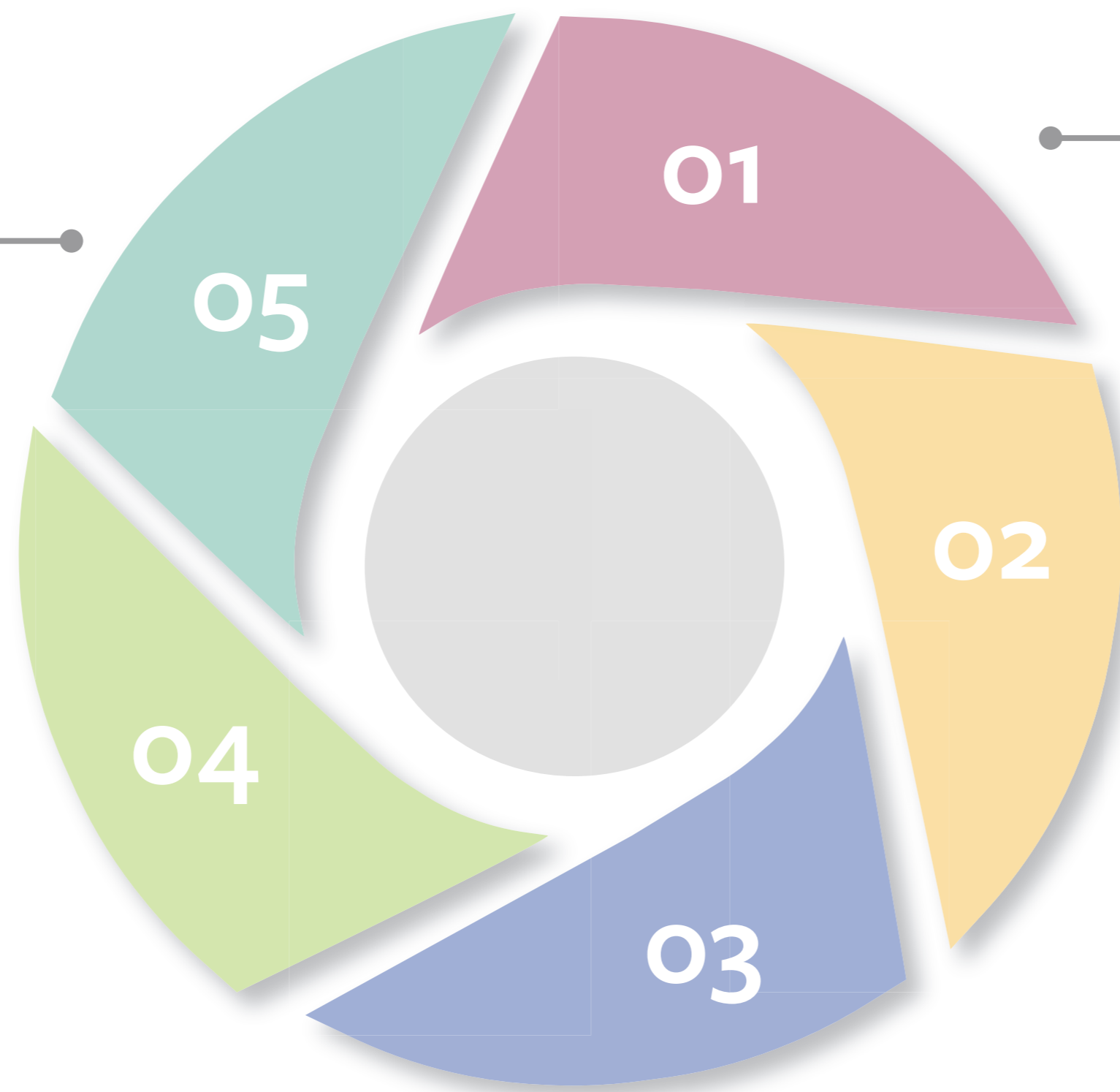

A NEW COMMUNITY HUB

IMPROVEMENTS TO GLAZEBURY'S FACILITIES

ENABLING RESIDENTIAL DEVELOPMENT

ENABLING RESIDENTIAL DEVELOPMENT

An element of enabling residential development will be required to **generate the investment** necessary to provide the potential **community benefits**.

Please use this opportunity to tell us what type of housing might be needed in Glazebury.

For example, is there a need for bungalows to allow **downsizing**? Is there a need for **starter homes**? Is there a need for **family housing**? Please provide us with your feedback.

PRECEDENT IMAGERY - WHAT WOULD YOU LIKE TO SEE IN GLAZEBURY?

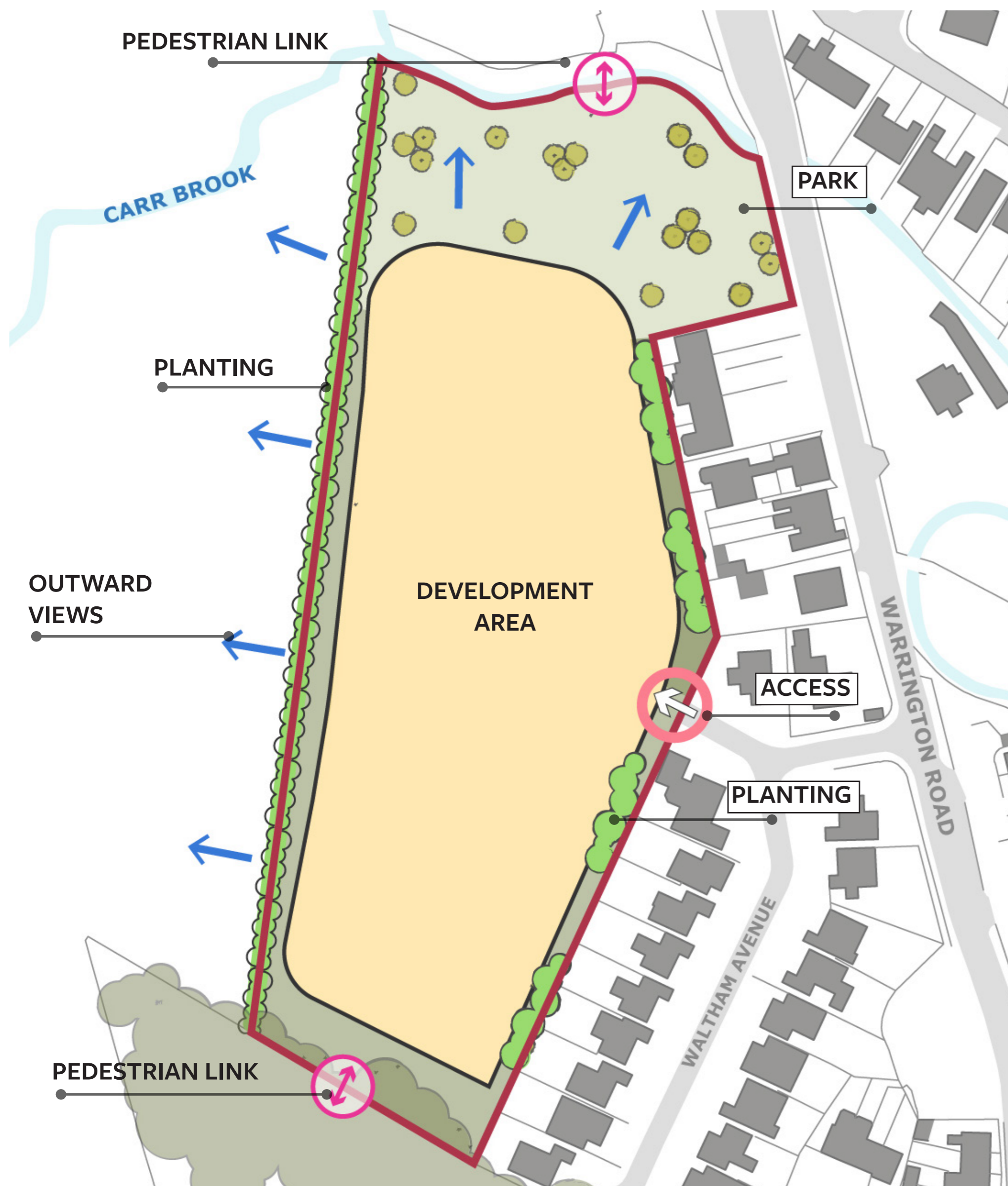

ENSURING A POSITIVE AND SENSITIVE RELATIONSHIP WITH THE ADJACENT FARMLAND



ENHANCING THE BANKS OF CARR BROOK AND SECURING A BIODIVERSITY NET GAIN



A LANDSCAPE LED RESIDENTIAL DEVELOPMENT



HIGH QUALITY MODERN HOUSING THAT REFLECTS THE CHARACTER OF THE VILLAGE

OUR GOALS

WORKING WITH THE COMMUNITY

Obtaining and using the feedback gathered from the community to inform the emerging proposals, to ensure investment is directed to provide the assets and facilities that you need.

INVESTING IN THE COMMUNITY

We will facilitate significant private sector investment into the community.

CREATING A COMMUNITY HUB

We aim to provide the community with a building and spaces that can be used by all ages and abilities for a range of activities.

STIMULATING LOCAL GROWTH

New development will stimulate growth in both the local economy, (via financial investment) and Glazebury's community (by providing a new community, sport and general recreational facilities).

DELIVERING A CHOICE OF HOUSING

The proposals will offer a mix of housing in terms of type, tenure, and size to meet the needs identified by the community.

DELIVERING HIGH QUALITY NEW HOMES

The building of high quality, sustainable homes that reflects the character and setting of the village.

HAVE YOUR SAY

The input from Glazebury's community will be key in helping us to shape and finalise the proposals, ensuring that the scheme is fully informed and delivers multiple benefits to the Glazebury community.

Thank you for taking the time and sharing your opinion and telling us what you would like to see and come forward in Glazebury.

We believe this is a **great opportunity** to provide **significant community benefits in Glazebury**, supported by an element of enabling residential development.

Our representatives will provide you with a comments form which you can complete today, or alternatively you can provide comments later by:

Email: hello@glazeburyconsultation.com

Website: www.glazeburyconsultation.com

Post: **Urban Green**
Ground Floor, The Tower
Deva City Office Park, Trinity Way
Manchester, M3 7BF

